

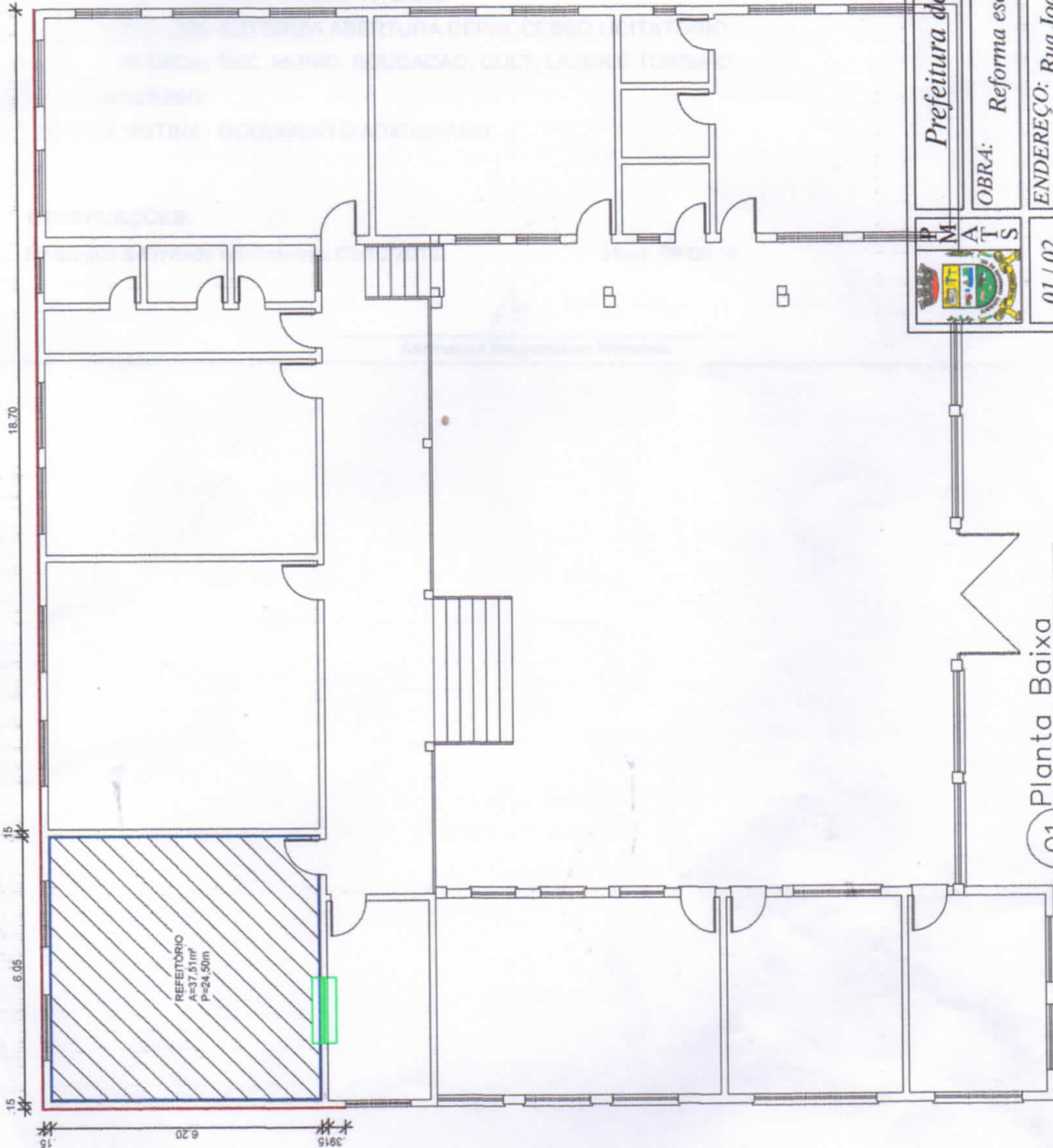



- Pintura Acrílica h=3,00m  
 - Pintura Acrílica h=1,50m  
 - Rev. Cerâmico h=1,50m

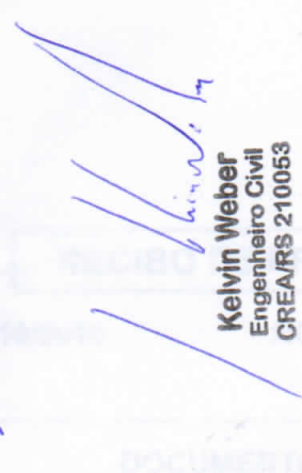

  
**Valdeci Gomes da Silva**  
 Prefeito Municipal

  
**Kelvin Weber**  
 Engenheiro Civil  
 CREA/RS 210053

	
<b>Prefeitura de Almirante Tamandaré do Sul</b>	
<b>OBRA:</b> Reforma escolas - Escola Bento Gonçalves	
<b>ENDEREÇO:</b> Rua Joaquim Grespan	
<b>PROJETO:</b> Arquitetônico	
<b>01 / 02</b>	<b>28/05/2018</b>
<b>ESCALA:</b> 1 / 50	

01 Planta Baixa  
 Escola Bento Gonçalves  
 Refeitório